

RETAIL SPACE FOR LEASE

10753 S US Highway 1, Port St. Lucie, FL

ESTIMATED COMPLETION 2nd Qtr. 2026



BRAY REALTY ADVISORS

Elevation



DESCRIPTION

- Former Golden Corral building
11,202 +/- SF
 - **UPDATE: Leased**
- New retail building/7,900 +/- SF
 - Includes drive-thru
 - Can be divided into 4 bays (80 ft deep, 25-35 ft wide)
- 5.47 +/- Acres
- Zoning: General Commercial, St. Lucie County
- High Traffic Location on US Highway 1
- Adjacent to Walmart Supercenter
- Cross Access with Walmart
- High Traffic Counts 50,500 ADT
- Approximately 453.65' of frontage on US Hwy 1

FLOOR PLAN

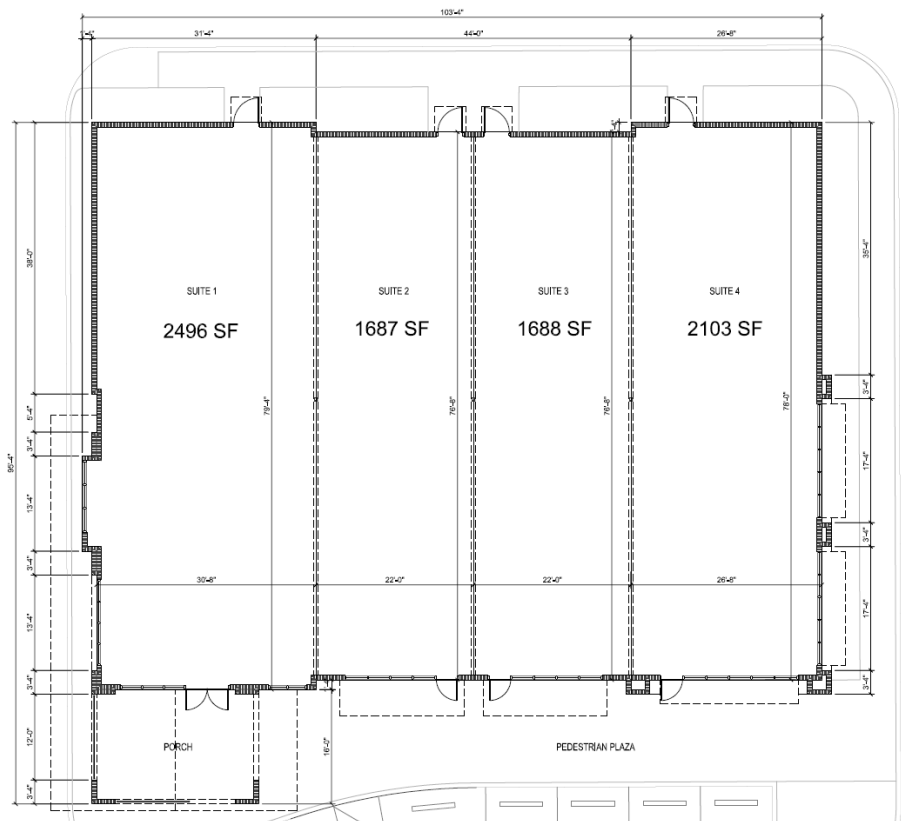

CALL US

NATE BRAY
(561) 317-6621
njb@brayrealtyadvisors.com

JOHN DELRUSSO
(818) 424-1105
jdr@brayrealtyadvisors.com

RETAIL SPACE FOR LEASE

10753 S US Highway 1, Port St. Lucie, FL

ESTIMATED COMPLETION 2nd Qtr. 2026



BRAY REALTY ADVISORS

